

MEROPE 140 / MEROPE 140 AD

SPECIFICATIONS

base code	67036 MEROPE 140 - 67034 MEROPE 140 AD
typology	MEROPE 140: Uplight with a drive over load of 3,5 tonnes / 7000 lbs. MEROPE 140 AD: Adjustable uplight with a drive over load of 3,5 tonnes / 7000 lbs
mounting	Using housing box to be separately ordered as accessory
diameter	Flush faceplate: 140 mm / 5.5" Protruding faceplate: 150 mm / 5.9"
height	MEROPE 140 / 140 AD: 100 mm / 3.9"
required depth	136 - 196 mm / 5.4" - 7.7"
first fit requirement	Yes, separate housing box: code 69561 for millimetric height adjustment from 0 to 50 mm / from 0" to 2"
floor cut out	175 mm / 6.9"
construction	Fixture: turning and milling aluminum. Faceplate in stainless steel AISI 304. Stainless steel A2 screws. Protective tempered glass complete with silicone gasket. Reflector: polycarbonate. Housing box in PVC
finishes	Fixture anodized and faceplate in brushed stainless steel AISI 304. Glass surface
ingress protection	IP67. North America wet location. Built-in protection from water infiltration and moisture
lamp type	COB. Remote power supply not included
lamp wattage	MEROPE 140: 20W at 48V DC. North America 700 mA MEROPE 140 AD: 12W at 48V DC. North America 350 mA
lamp lumens	MEROPE 140: 2480lm. MEROPE 140 AD: 1320lm
delivered lumens	MEROPE 140: 920lm. MEROPE 140 AD: 400lm
lumen maintenance	50.000h L90
beam	12°, 24°, 32°. Honeycomb for visual comfort included. MEROPE 140 AD: Tilt system, from 0° to 20° allowing adjustment without opening the luminaire. Honeycomb for visual comfort included
kelvin	2700K CRI93, 3000K CRI93 and 4000K CRI93 / 3 step MacAdam ellipse
special features	Water stop technology. 48V DC: unpolarized electronic system - Thermal Sensor - Safe wiring
dimming options	Push button, potentiometer, 0-10V, DALI, DMX, KNX. Dimming options depend on power supply and additional control units to be separately ordered as accessories
listings	CE, ETL listed for wet location



MEROPE 140 - PROTRUDING FACEPLATE

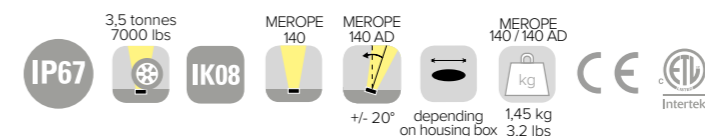



MEROPE 140 / MEROPE 140 AD

ORDER CODE

BASE CODE	A . POWER SUPPLY	B . KELVIN	C . BEAM
67036 MEROPE 140 20W	8 48V DC power supply NOT included	4 4000K CRI93	2 spot 12°
67034 MEROPE 140 AD 12W	U  listed 350/700 mA power supply NOT included	5 3000K CRI93	4 flood 24°
		8 2700K CRI93	5 wide flood 32°

Example: BASE CODE **67036** A **8** B **5** C **2** D **A** E **S** = **67036-852AS**

D . FINISHES

A stainless steel flush faceplate



B stainless steel protruding faceplate



E . OTHER

S screws on faceplate



N no screws on faceplate²



² the faceplate can be removed without tools. Don't choose this option when the fixture will be installed in public spaces.

Available for North America only

MEROPE 140

Beam angles: 12°, 24°, 32°



MEROPE 140 AD

Beam angles: 12°, 24°, 32°

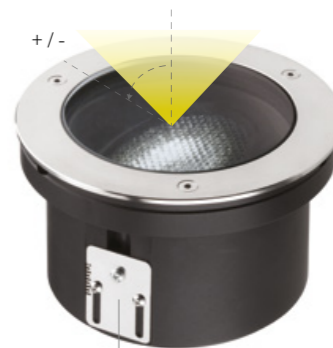

TILT SYSTEM ALLOWING ON SITE ADJUSTMENT FROM 0° TO 20° WITHOUT OPENING THE LUMINAIRE

FACEPLATE OPTIONS

PROTRUDING FACEPLATE

finished floor level

FLUSH FACEPLATE

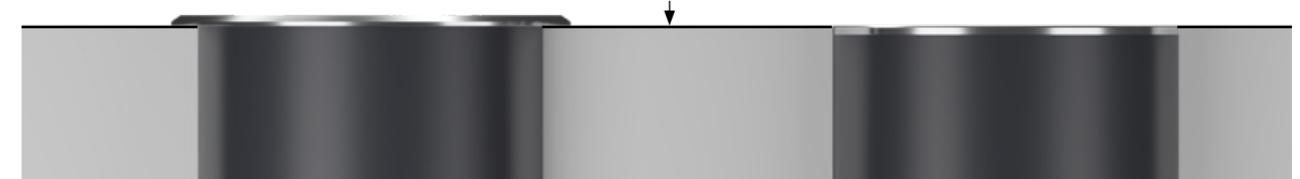



MEROPE 140 / MEROPE 140 AD

ACCESSORIES

REQUIRED ACCESSORIES - NOT INCLUDED

69561		Power supply 48V DC*, ON/OFF	code	description	dimensions mm			
	120 - 170 4.7' - 6.7'		69561	height adjustable housing box for concrete	Ø195xH120-170			
	Ø 195 / 7.7"		69593	suction cup for the extraction of the luminaire	W80xH50			
69593		Power supply 48V DC*, ON/OFF ambient temperature up to 60° C	code	output power	input voltage / frequency	IP	dimensions mm	
	50 / 2"		69180	30W	90-264V	47-63Hz	IP20	L160xW46xH30
	Ø 80 / 3.2"		69185	40W	90-305V	47-63Hz	IP67	L171xW62xH37
			69186	60W	90-305V	47-63Hz	IP67	L171xW62xH37
			69187	100W	90-305V	47-63Hz	IP67	L220xW68xH39
			69188	150W	90-305V	47-63Hz	IP67	L228xW68xH39
			69195	75W	100-305V	47-63Hz	IP67	L180xW63xH36
			69196	100W	100-305V	47-63Hz	IP67	L199xW63xH36
			69197	150W	100-305V	47-63Hz	IP67	L219xW63xH36
			*on / off only					
		Class 2 power supply 24V DC 350 mA 700 mA	Consult B LIGHT North America Lighting Group Network T: 212.775.6363 E: info@lightinggroupnetwork.com					
69841			code	description	dimensions mm			
	42 1.7"		69841	IP68 connector, 1 IN - 1 OUT, 3 wires	W42xD29xH42			
69843			69843	IP68 connector, 1 IN - 3 OUT, parallel wiring, 4 wires	W78xD30xH20			
	78 3.1"							